



Thesis 2007

Pennsylvania State University
State College, PA 06802

KHA N DANG, LC INTERN
ARCHITECTURAL ENGINEERING
LIGHTING | ELECTRICAL option

T: 267 229 9370
E: kind107@gmail.com
W: www.arch.psu.edu/thesis/portfolio/2007/
portfolio/knd107
C: Dr. Richard Mistrick
C2: Ted Damerth

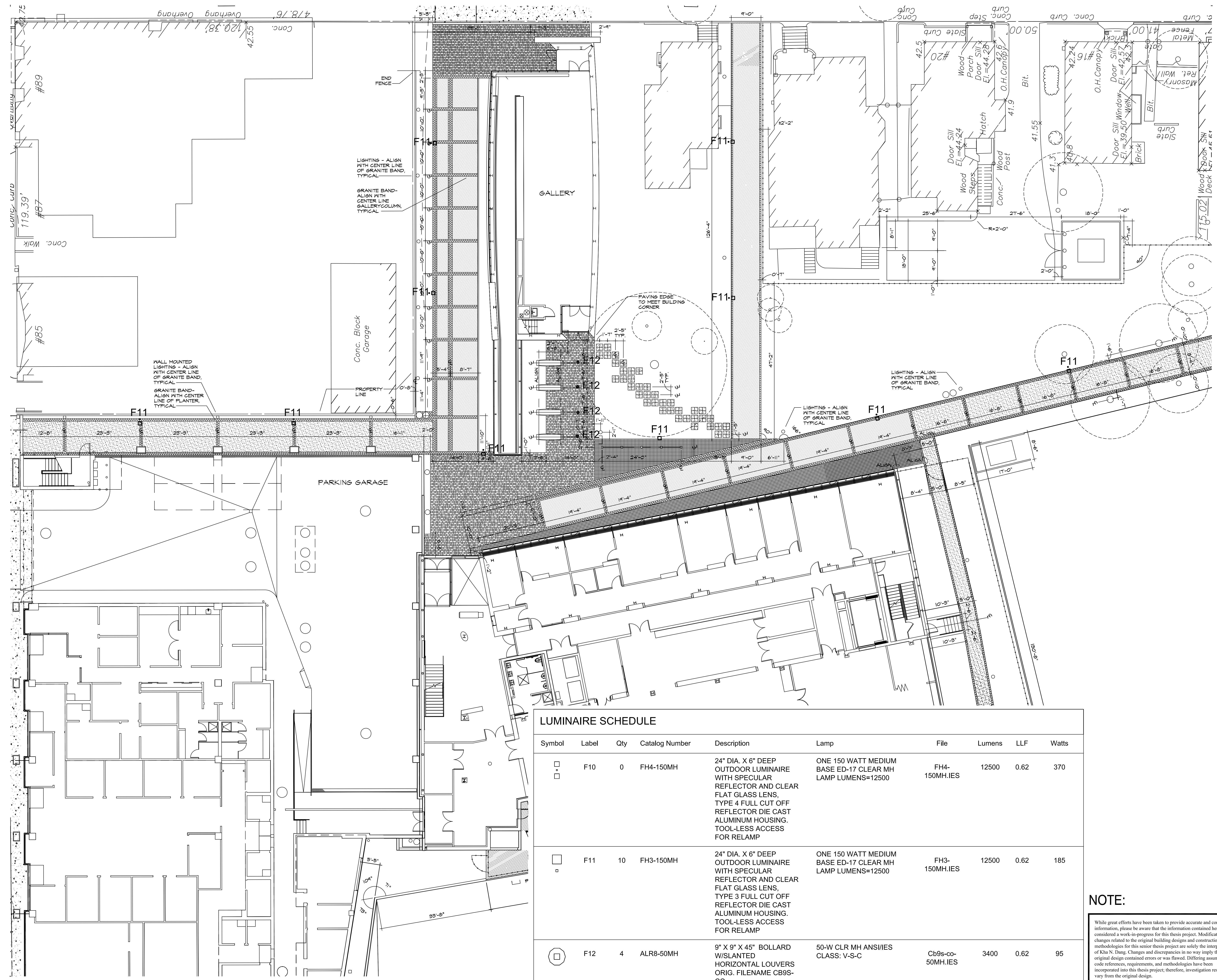

LUMINAIRE SCHEDULE									
Symbol	Label	Qty	Catalog Number	Description	Lamp	File	Lumens	LLF	Watts
□	F10	0	FH4-150MH	24" DIA. X 6" DEEP OUTDOOR LUMINAIRE WITH SPECULAR REFLECTOR AND CLEAR FLAT GLASS LENS, TYPE 4 FULL CUT OFF REFLECTOR DIE CAST ALUMINUM HOUSING. TOOL-LESS ACCESS FOR RELAMP	ONE 150 WATT MEDIUM BASE ED-17 CLEAR MH LAMP LUMENS=12500	FH4-150MH.IES	12500	0.62	370
□	F11	10	FH3-150MH	24" DIA. X 6" DEEP OUTDOOR LUMINAIRE WITH SPECULAR REFLECTOR AND CLEAR FLAT GLASS LENS, TYPE 3 FULL CUT OFF REFLECTOR DIE CAST ALUMINUM HOUSING. TOOL-LESS ACCESS FOR RELAMP	ONE 150 WATT MEDIUM BASE ED-17 CLEAR MH LAMP LUMENS=12500	FH3-150MH.IES	12500	0.62	185
⊙	F12	4	ALR8-50MH	9" X 9" X 45" BOLLARD W/SLANTED HORIZONTAL LOUVERS ORIG. FILENAME CB9S-CO	50-W CLR MH ANSI/IES CLASS: V-S-C	Cb9s-co-50MH.IES	3400	0.62	95

NOTE:

While great efforts have been taken to provide accurate and complete information, please be aware that the information contained herewith is considered a work-in-progress for this thesis project. Modifications and changes related to the original building designs and construction methodologies for this senior thesis project are solely the interpretation of Kha N. Dang. Changes and discrepancies in no way imply that the original design contained errors or was flawed. Differing assumptions, code references, requirements, and methodologies have been incorporated into this thesis project; therefore, investigation results may vary from the original design.

NOT FOR CONSTRUCTION

NO.	DATE	REVISION

PROJECT NAME
**THESIS 2007
SCULPTURE BIDG
PARKING GARAGE**

BUILDING NAME & ADDRESS

PROJECT NUMBER

DRAWING TITLE
EXTERIOR LIGHTING LAYOUT

SCALE
3/8" = 1'-0"

DRAWN BY
KND

CAD FILENAME
XX-XX-XXX.DWG

DATE
03/11/07

DRAWING NUMBER

CS-100